

# Directions to VMI RFC

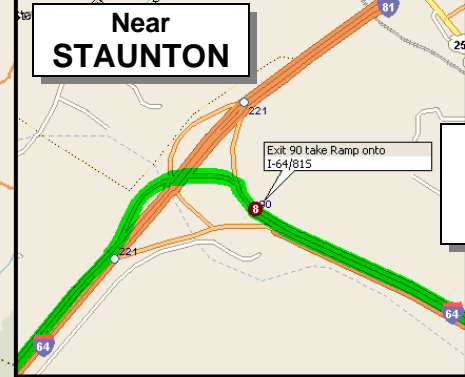

**Phone Numbers**  
**JAKE**  
**C: (240)377-6334**

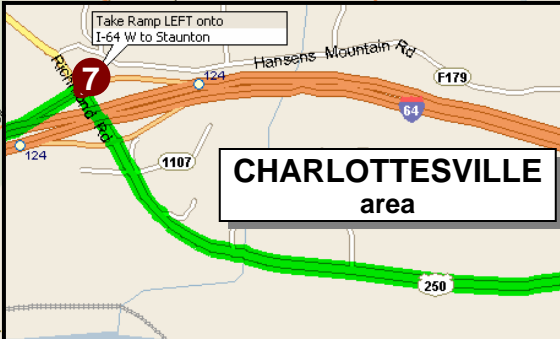
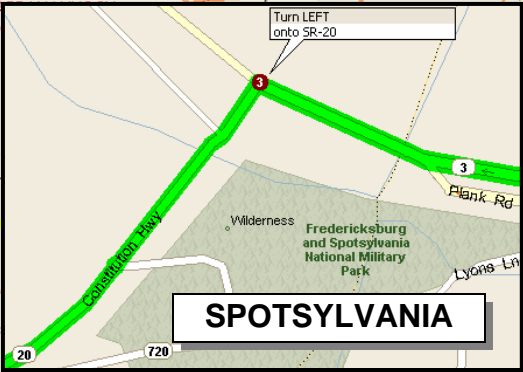
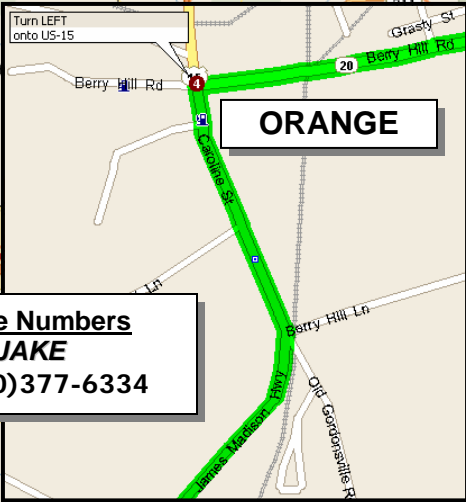

**DETAILED ON BACK**

Summary: 153.2 miles (3 hours, 01 minutes)

| Time  | Mile  | Instruction  | For     | Toward                |
|-------|-------|--|---------|-----------------------|
| 08:15 | 0.0   | Depart BARNETT FIELD PARKING LOT   | 4.2 mi  |                       |
| 08:25 | 4.2   | <b>1</b> Take Ramp (RIGHT) onto I-95                                       | 17.8 mi | I-95 / Fredericksburg |
| 08:42 | 22.0  | <b>2</b> At exit 130, take Ramp (RIGHT) onto SR-3 [Plank Rd]               | 0.7 mi  |                       |
| 08:43 | 22.7  | Keep STRAIGHT onto SR-3 [Germanna Hwy]                                     | 12.2 mi |                       |
| 08:59 | 34.9  | <b>3</b> Turn LEFT (South-West) onto SR-20 [Constitution Hwy]              | 22.3 mi |                       |
| 09:27 | 57.2  | <b>4</b> Turn LEFT (South) onto US-15 [Caroline St]                        | 8.4 mi  |                       |
| 09:39 | 65.6  | <b>5</b> Enter Traffic Circle, Exit (RIGHT) onto SR-231S [W Gordon Ave]    | 2.0 mi  |                       |
| 09:40 | 67.7  | Keep STRAIGHT onto SR-231 [Gordonsville Rd]                                | 7.5 mi  |                       |
| 09:52 | 75.2  | Road name changes to Louisa Rd   | 5.4 mi  |                       |
| 10:01 | 80.5  | <b>6</b> Keep STRAIGHT onto US-250 [Richmond Rd]                           | 2.1 mi  |                       |
| 10:05 | 82.6  | <b>7</b> Take Ramp (LEFT) onto I-64  | 36.8 mi |                       |
| 10:40 | 119.4 | <b>8</b> At exit 90, turn off onto Ramp, Take Ramp (LEFT) onto I-64 [I-81] | 30.5 mi |                       |

**Saturday, 8 March, 2008**  
**VMI RFC**  
 (Virginia Military Institute Parade Deck, Lexington, Va.)  
**SCHEDULE:**  
**08:00** Rally @ Barnett Field Parking Lot  
**NLT 08:15** Depart Quantico for Match.  
**NLT 08:45** Depart Fredericksburg area.  
**≈ 11:15** Arrive at **VMI Parade Deck**.  
**11:45** **Boots On** - Warm up/match prep.  
**13:00** Kick off.  
**≈ 15:30** Push for Social (**TBD**).

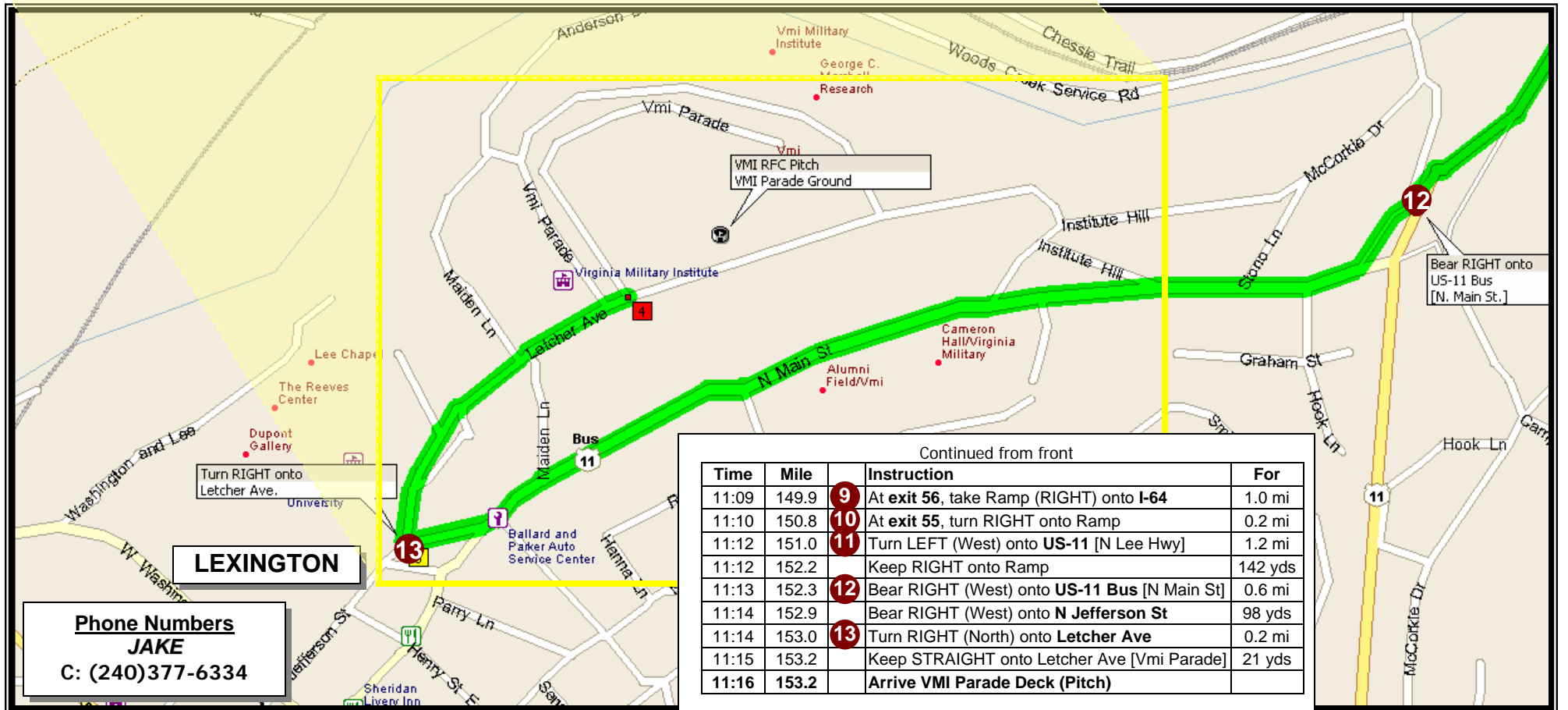

**Phone Numbers**  
**JAKE**  
**C: (240)377-6334**

Continued from front

| Time  | Mile  | Instruction  | For     |
|-------|-------|--|---------|
| 11:09 | 149.9 | <b>9</b> At exit 56, take Ramp (RIGHT) onto I-64       | 1.0 mi  |
| 11:10 | 150.8 | <b>10</b> At exit 55, turn RIGHT onto Ramp             | 0.2 mi  |
| 11:12 | 151.0 | <b>11</b> Turn LEFT (West) onto US-11 [N Lee Hwy]      | 1.2 mi  |
| 11:12 | 152.2 | Keep RIGHT onto Ramp                                   | 142 yds |
| 11:13 | 152.3 | <b>12</b> Bear RIGHT (West) onto US-11 Bus [N Main St] | 0.6 mi  |
| 11:14 | 152.9 | Bear RIGHT (West) onto N Jefferson St                  | 98 yds  |
| 11:14 | 153.0 | <b>13</b> Turn RIGHT (North) onto Letcher Ave          | 0.2 mi  |
| 11:15 | 153.2 | Keep STRAIGHT onto Letcher Ave [Vmi Parade]            | 21 yds  |
| 11:16 | 153.2 | Arrive VMI Parade Deck (Pitch)                         |         |